

HS#637924

REPORT NUMBER: 301S-MGA-05-003

**SAFETY COMPLIANCE TESTING FOR
FMVSS NO. 301S
FUEL SYSTEM INTEGRITY - SCHOOL BUSES**

**Les Entreprises Michel Corbell Inc.
2004 Corbell 30 Passenger School Bus
NHTSA No. C40902**

**PREPARED BY:
MGA RESEARCH CORPORATION
5000 WARREN ROAD
BURLINGTON, WI 53105**



Final Report Date: July 6, 2005

FINAL REPORT

**PREPARED FOR:
U.S. DEPARTMENT OF TRANSPORTATION
NATIONAL HIGHWAY TRAFFIC SAFETY ADMINISTRATION
ENFORCEMENT
OFFICE OF VEHICLE SAFETY COMPLIANCE
400 SEVENTH STREET, SW, ROOM 6115 (NVS-224)
WASHINGTON, D.C. 20590**

This publication is distributed by the U.S. Department of Transportation, National Highway Traffic Safety Administration, in the interest of information exchange. The opinions, findings and conclusions expressed in this publication are those of the author(s) and not necessarily those of the Department of Transportation or the National Highway Traffic Safety Administration. The United States Government assumes no liability for its contents or use thereof. If trade or manufacturers' names or products are mentioned it is only because they are considered essential to the object of the publication and should not be construed as an endorsement. The United States Government does not endorse products or manufacturers.

Prepared by:  Date: July 6, 2005
James Hansen, Program Engineer

Reviewed by:  Date: July 6, 2005
David Winkelbauer, Program Manager

FINAL REPORT ACCEPTED BY:

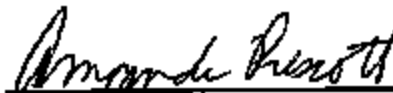

7/11/05
Date of Acceptance

Technical Report Documentation Page

1. Report No. 301S-MGA-05-003		2. Government Accession No.		3. Recipient's Catalog No.	
4. Title and Subtitle Final Report of FMVSS 301S School Bus Compliance Testing of 2004 Corbeil 30 Passenger School Bus NHTSA No.:C40902				5. Report Date July 8, 2005	
				6. Performing Organization Code MGA	
7. Author(s) James Hansen, Program Engineer David Winkelbauer, Program Manager				8. Performing Organization Report No. 301S-MGA-05-003	
9. Performing Organization Name and Address MGA Research Corporation 5000 Warren Road Burlington, WI 53105				10. Work Unit No.	
				11. Contract or Grant No. DTNH22-02-D-01057	
12. Sponsoring Agency Name and Address U.S. Department of Transportation National Highway Traffic Safety Administration Enforcement Office of Vehicle Safety Compliance (NVS-224) 400 Seventh St., S.W. Room 6115 Washington, D.C. 20590				13. Type of Report and Period Covered Final Report June 15 - July 8, 2005	
				14. Sponsoring Agency Code NVS-224	
15. Supplementary Notes					
16. Abstract A compliance test was conducted on the subject 2004 Corbeil 30 passenger School Bus, NHTSA No. C40902 in accordance with the specifications of the Office of Vehicle Safety Compliance Test Procedure No. TP-301S-02 for the determination of FMVSS 301S compliance. Test failures were as follows: None					
17. Key Words Compliance Testing Safety Engineering FMVSS 301S				18. Distribution Statement Copies of this report are available from: NHTSA Technical Information Services (TIS) Room 2336, (NPO-405) 400 Seventh Street, S.W. Washington, D.C. 20590 (202) 366-4948	
19. Security Classif. (of this report) Unclassified		20. Security Classif. (of this page) Unclassified		21. No. of Pages 38	22. Price

TABLE OF CONTENTS

<u>Section</u>		<u>Page No</u>
1	Purpose of Compliance Test and Summary	1
2	Compliance Test Data	2
	Data Sheet 1 - School Bus Data	3
	Data Sheet 2 - School Bus Data	5
3	Instrumentation and Equipment List	7
4	Photographs	8
5	Barrier Information	32

SECTION 1

PURPOSE OF COMPLIANCE TEST AND SUMMARY

A fuel system integrity test was performed on a MY2004 Corbell 30 Passenger School Bus, NHTSA No. C40902, in accordance with the specifications of the Office of Vehicle Safety Compliance (OVSC) Test Procedures TP-301S-02 to determine compliance to the requirements of Federal Motor Vehicle Safety Standards (FMVSS) 301S, "Fuel System Integrity - School Buses".

Based on the test results, the MY2004 Corbell 30 Passenger School Bus, NHTSA No. C40902 appears to meet the requirements of FMVSS 301S testing.

This program is sponsored by the National Highway Traffic Safety Administration (NHTSA), under Contract No. DTNH22-02-D-01057.

SECTION 2
COMPLIANCE TEST DATA

The following data sheets document the results of testing on the MY2004 Corbail 30 Passenger School Bus, NHTSA No. C40902.

**DATA SHEET 1
SCHOOL BUS DATA**

Test Vehicle: **2004 Corbell 30 Passenger School Bus**
 Test Lab: **MGA Research-Wisconsin Operations**

NHTSA No.: **C40902**
 Test Date: **6/15/05**

GENERAL VEHICLE IDENTIFICATION

School Bus Manufacturer:	Corbell	
School Bus Model:	30 Passenger	
Build Date:	05/04	
Incomplete Vehicle Manufactured By:	Ford	
Build Date for Bus Chassis:	03/04	
School Bus GVWR (kg):	8372	
School Bus GAWR Front (kg):	2088	
School Bus GAWR Rear (kg):	4286	
School Bus VIN:	1FDXE45P14HA89680	
No. of Designated Seating Positions (DSP) including Driver:	31	
School Bus NHTSA No.:	C40902	
Bus Body Color:	Yellow	
Engine Displacement	6.0L	
No. of Cylinders:	8	
Fuel Pump Actuation:	Electrical Pump "ON" with ignition	
School Bus Width (mm):	2430	
School Bus Length (mm):	7110	
Bus Unloaded Vehicle Weight (UVW) (kg):	4308	
Bus Occupant Load:	1620 kg - Passenger 68 kg - Driver 1688 kg - Total	
Target Bus Test Weight (SBTW) (kg):	5996	
Actual (SBTW) (kg):	5992	
School Bus Tire Manufacturer:	Michelin	
	Front	Rear
Rec. Cold Tire Inflation Pressure (kpa):	450	550
Tire Size:	LT225/75R16	LT225/75R16
Load Range:	E	E

DATA SHEET 1 (CONTINUED)

SCHOOL BUS DATA

Test Vehicle: **2004 Corbell 30 Passenger School Bus**
 Test Lab: **MGA Research-Wisconsin Operations**

NHTSA No.: **C40902**
 Test Date: **6/15/06**

GENERAL VEHICLE IDENTIFICATION

SCHOOL BUS ATTITUDE

	Units	LF	RF	LR	RR
As Received:	mm	NR	NR	NR	NR
Pre-Test:	mm	884	870	850	880
Post-Test:	mm	891	873	847	851

NR = Not Recorded

Weight of Fuel:	3.19 kg/liter (7.03 lbs./gallon)
Fuel Tank Capacity (liters/kg):	218 liters/182 kg (57 gallons/401 lbs.)
Tank Test Volume (liters/kg):	201 liters/169 kg (53 gallons/373 lbs.)

TEST VEHICLE WEIGHTS

	Units	As Delivered (UVW)			As Tested (ATW)*		
		Front	Rear	Total	Front	Rear	Total
Left	kg	810	1304		842	2116	
Right	kg	858	1338		894	2140	
Ratio	%	38.7	61.3		29.0	71.0	
Totals	kg	1668	2642	4308	1736	4256	5992

COMMENTS: NONE

Recorded By: Jordan Hoyas

Approved By: [Signature]

Date: 6/15/06

DATA SHEET 2
SCHOOL BUS IMPACT DATA

Test Vehicle: **2004 Corbell 30 Passenger School Bus**
Test Lab: **MGA Research-Wisconsin Operations**

NHTSA No.: **C40902**
Test Date: **6/15/05**

Time of Impact:	4:11 pm
Ambient Temperature (°C)	21.1
Barrier Velocity – Speed Trap 1 (kph):	47.8
Barrier Velocity – Speed Trap 2 (kph):	47.8
Barrier Penetration:	120mm

INDICATE IMPACT POINT BELOW:

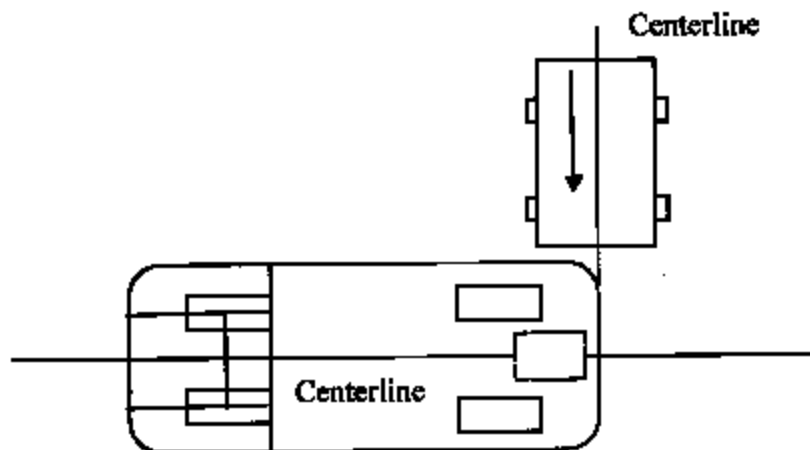

LEGEND: Red dotted line indicates location of fuel tank
Arrow indicates point and angle of barrier impact (C_L of arrow coincides with C_L of monorail).

DATA SHEET 2 (CONTINUED)
SCHOOL BUS IMPACT DATA

Fuel Spillage Noted:	No
Failure, if applicable:	None

Stoddard Solvent Spillage Measurements

Timeframe	Description	Allowable Spillage	Measured Spilled	Results
T ₀ - T ₁	Time Zero to Cessation of Motion	31 grams (1 ounce)	0	PASS
T ₁ - T ₂	Cessation of Motion to 5 minutes after Cessation of Motion	156 grams (5 ounces)	0	PASS
T ₂ - T ₃	5 Minutes after Cessation of Motion to 30 minutes after Cessation of Motion	31 grams (1 ounce) per minute 933 grams (30 ounces) Total Allowed	0	PASS

COMMENTS: None

Recorded By: Javelon Hoynes

Approved By: [Signature]

Date: 6/15/05

SECTION 3
INSTRUMENTATION AND EQUIPMENT LIST

Test Vehicle: 2004 Corbell 30 Passenger School Bus
Test Lab: MGA Research-Wisconsin Operations

NHTSA No.: C40902
Test Date: 6/15/05

Equipment	Description	Serial No.	Cal. Date	Next Cal. Date
Counter/Timer	DCI	939095	10/26/04	10/26/05
Counter/Timer	DCI	939094	10/26/04	10/26/05
Vehicle Scales	GSE	212091 & 212092	6/10/05	12/10/05
Tape Measure	Stanley Powerlock 8M	162	5/19/05	11/19/05

**SECTION 4
PHOTOGRAPHS**

TABLE OF PHOTOGRAPHS

<u>No.</u>		<u>Page No.</u>
1	Pre-Test Front View of School Bus	9
2	Post-Test Front View of School Bus	10
3	Pre-Test Left Side of School Bus	11
4	Post-Test Left Side of School Bus	12
5	Pre-Test Rear View of School Bus	13
6	Post-Test Rear View of School Bus	14
7	Pre-Test Right Front ¾ View of School Bus	15
8	Post-Test Left Front ¾ View of School Bus	16
9	Pre-Test Right Rear ¾ View of School Bus	17
10	Post-Test Left Rear ¾ View of School Bus	18
11	Vehicle Certification and Tire Information Label	19
12	Pre-Test Impact Target	20
13	Post-Test of Impact Location	21
14	Post-Test of Impact Location #2	22
15	Pre-Test of Barrier (left side)	23
16	Post-Test of Barrier (left Side)	24
17	Pre-Test of Barrier (right side)	25
18	Post-Test of Barrier (right side)	26
19	Pre-Test of Fuel Tank Cage	27
20	Post-Test of Fuel Tank Cage	28
21	Post-Test of Fuel Tank Cage (View #2)	29
22	Speed Trap Counter Display	30
23	Impact	31

Total Vehicle 2004 School Bus
Presented BYSS 301

NEISSA No. 410902

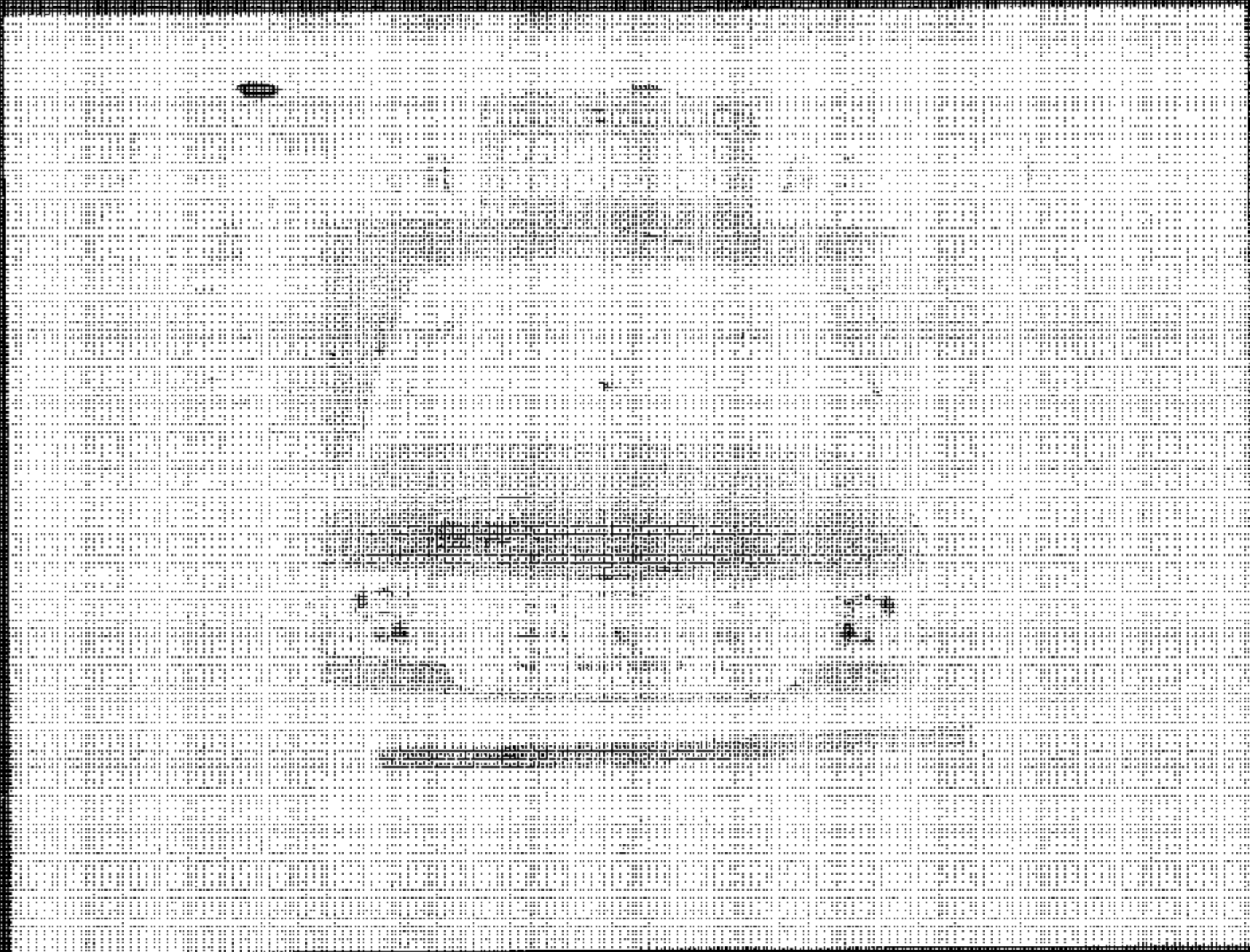

Front View of School Bus



Test Vehicle: 2014 Chevrolet Silverado 3500
Procedure: FMVSS 301

NHTSA No. C-35962

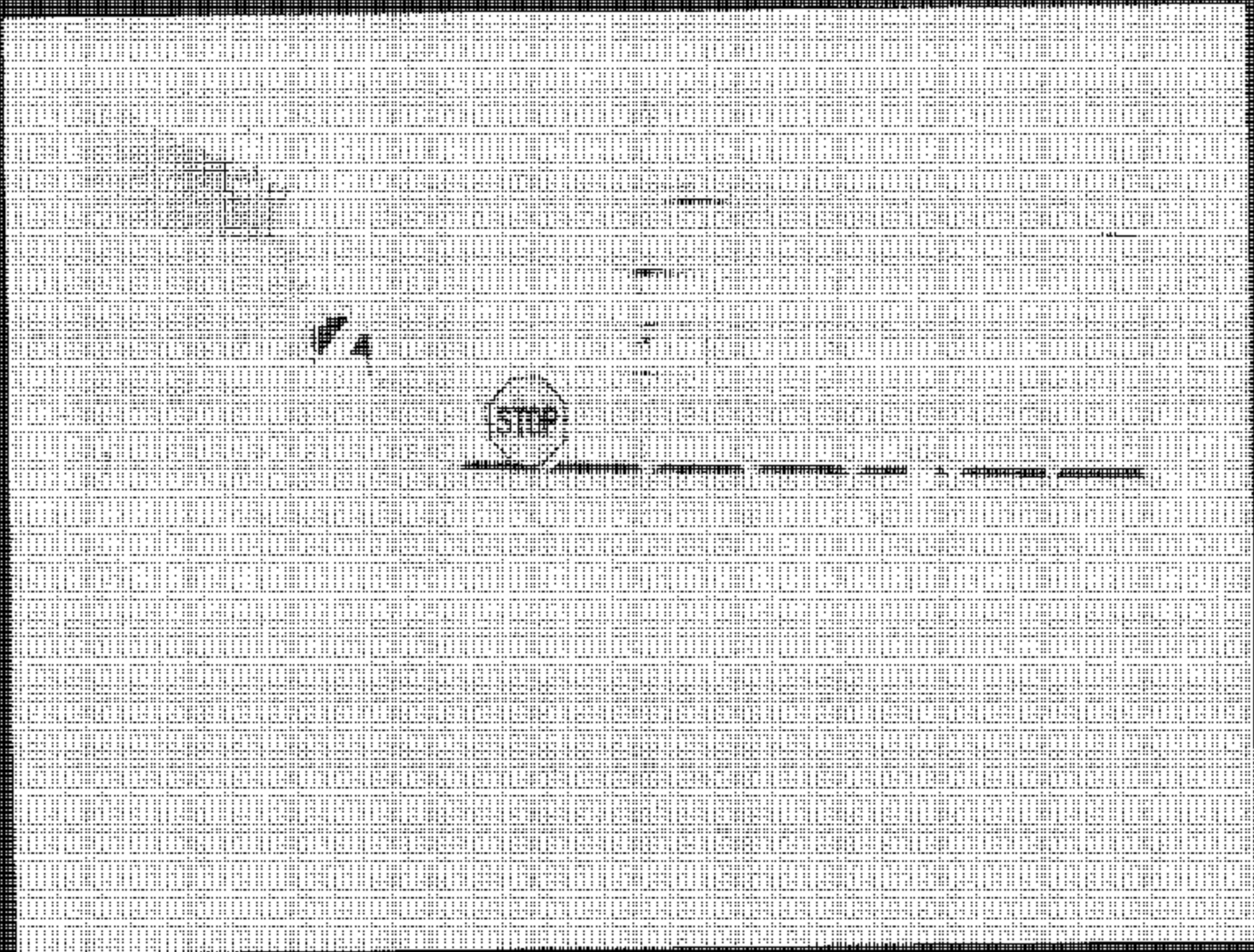

FBI WASH DC
FBI CHICAGO

Time Control 50 Passenger School Bus
#1456 501

NHTSA No. 045447

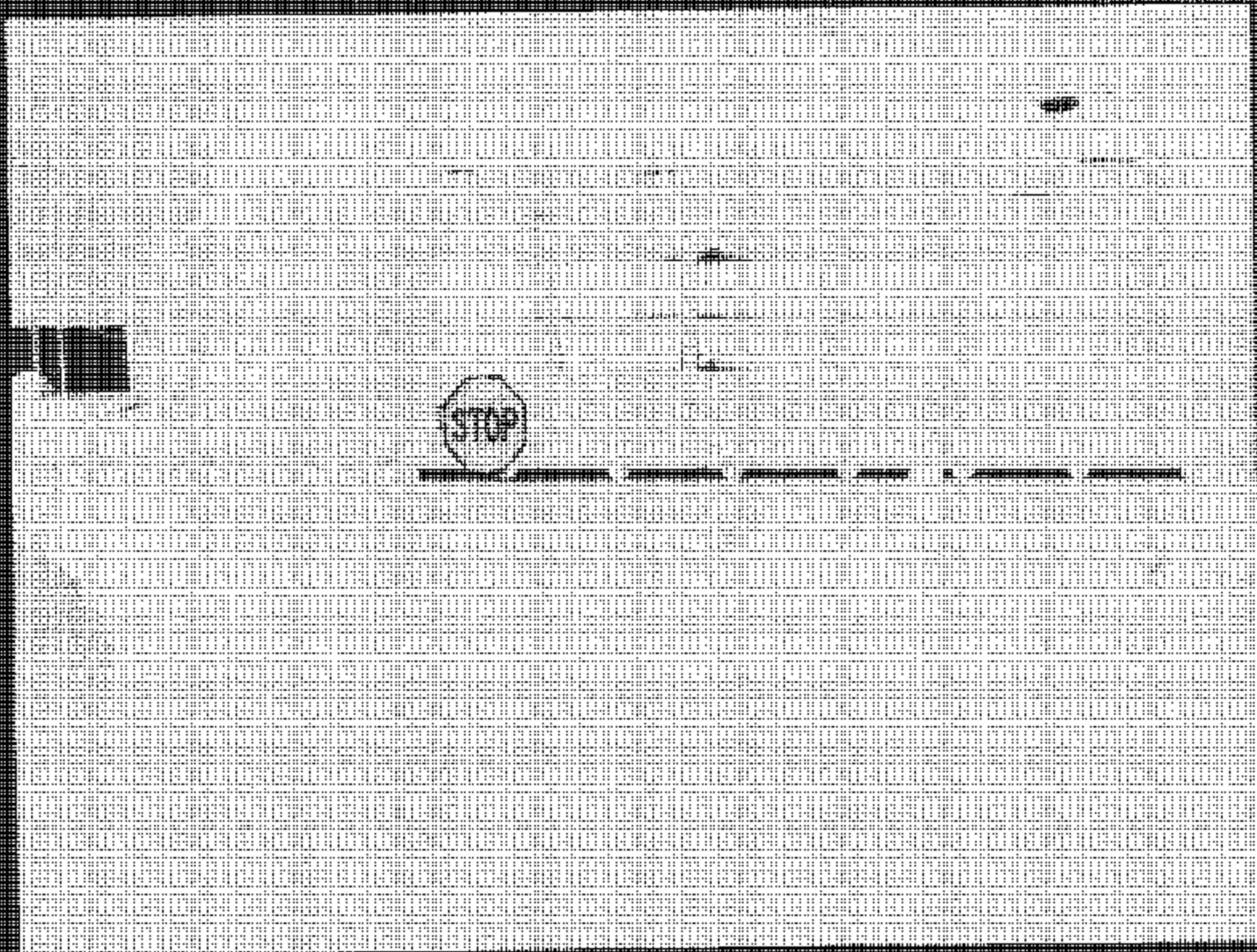

Free-Test Left Side of School Bus

71

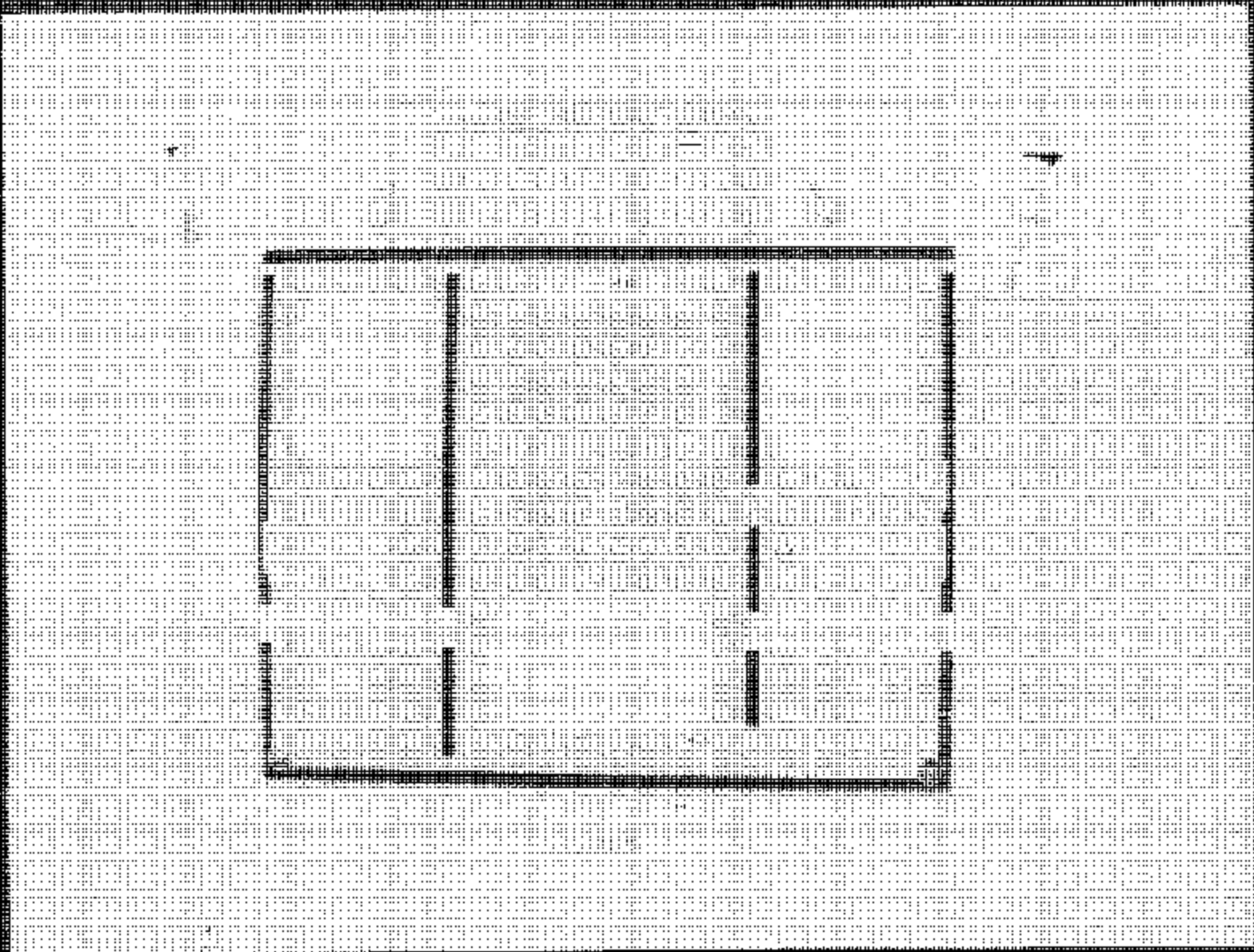

File No: 2004-G-00000-00-00000-00000-00000
Procedure: 2004-00000-00000-00000-00000

NALSA No. 00000

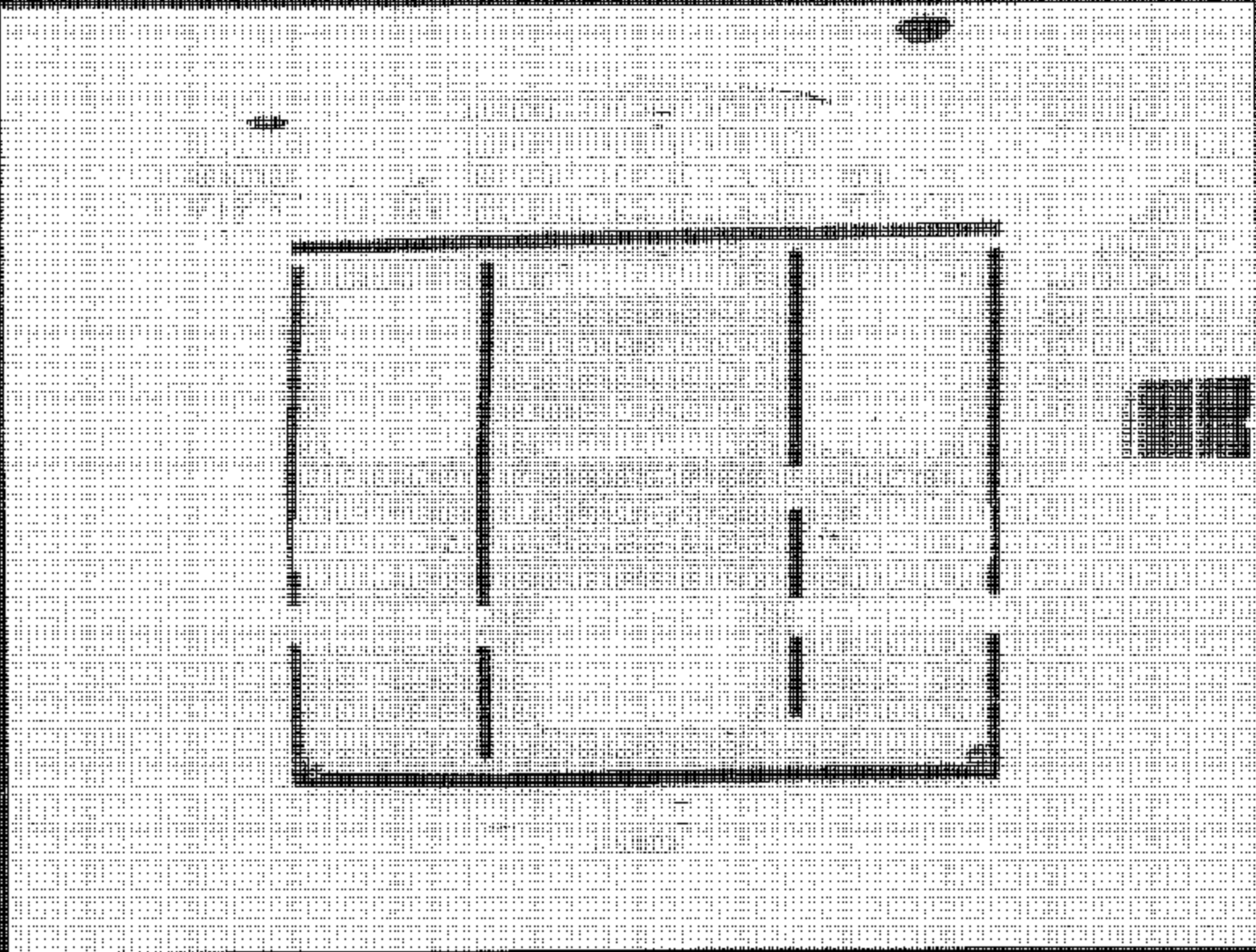

Post Test Rear View of School Bus

Total Volume: 2304 01/01/00 70 1/2
Frequency: Monthly

Report No. CA0502

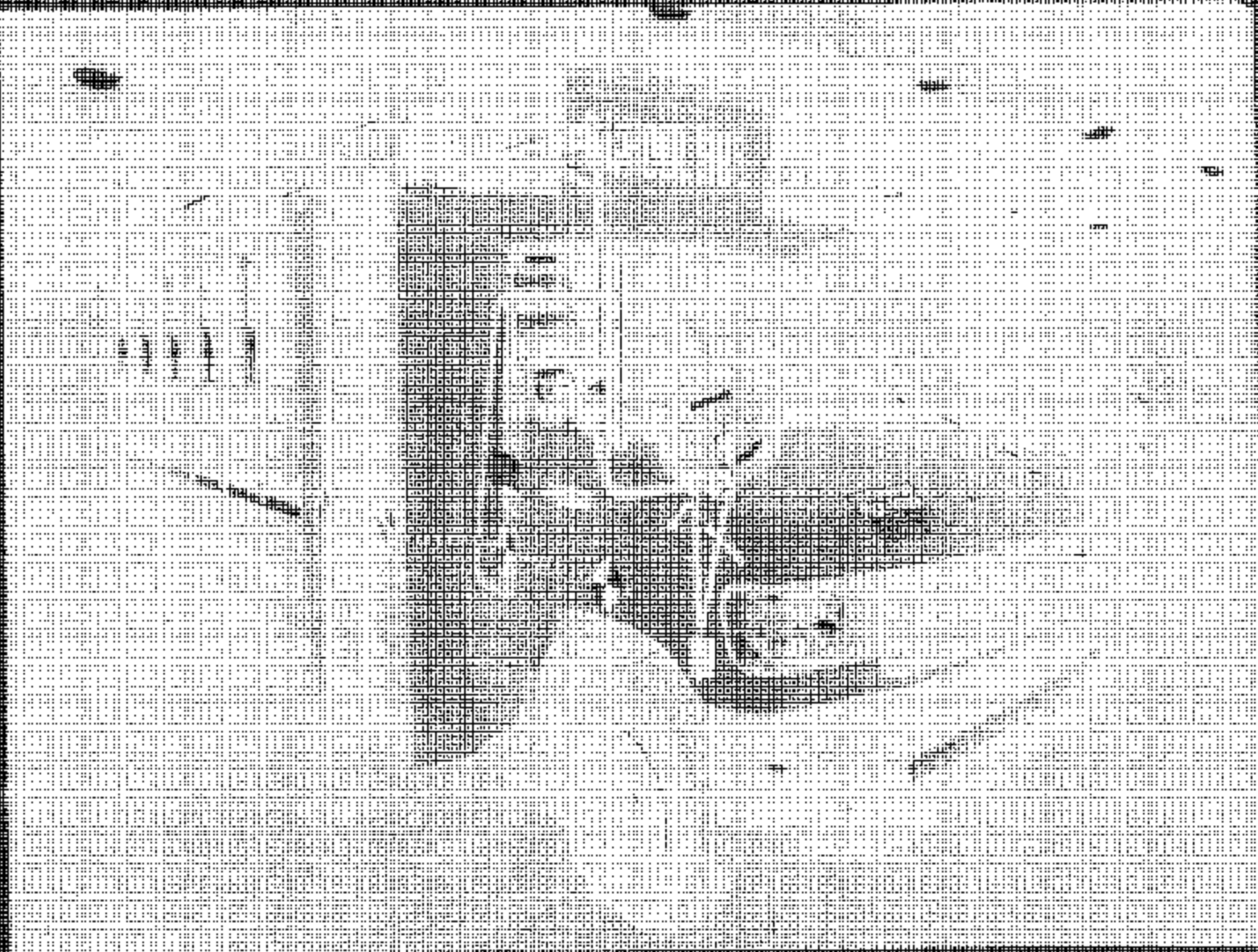

Pre-Tax Right Front 1/4 View of School Bus

Test Vehicle: 2014 Chevrolet 19 Passenger School Bus
Procedure: FMVSS 244

NHTSA No. C-16302

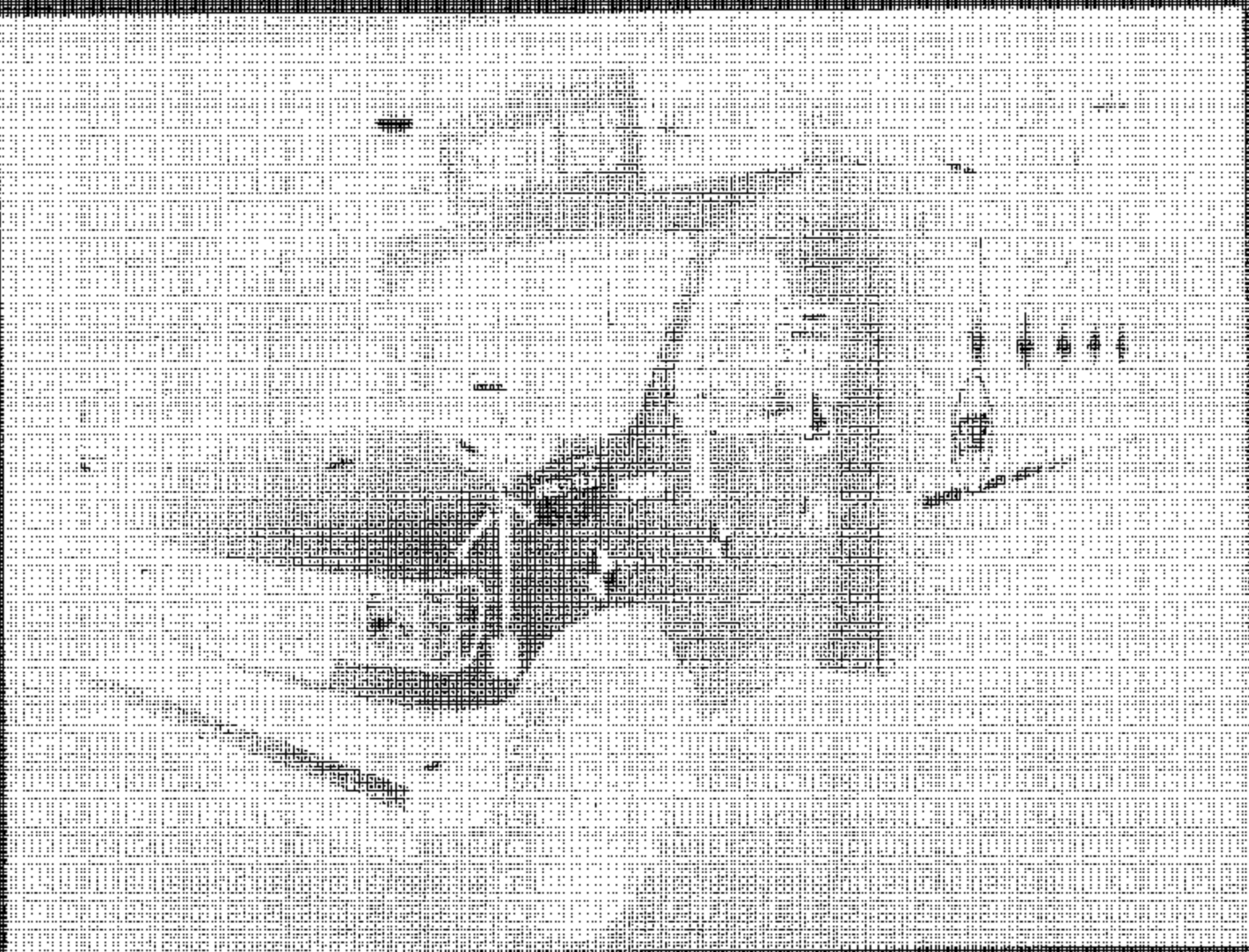

19

Post-Test Left Front 3/4 View of School Bus

Paul H. Hinkle
President

2106 S. 10th St. - Phoenix, Arizona 85004
ALYSS 301

ALYSS 301

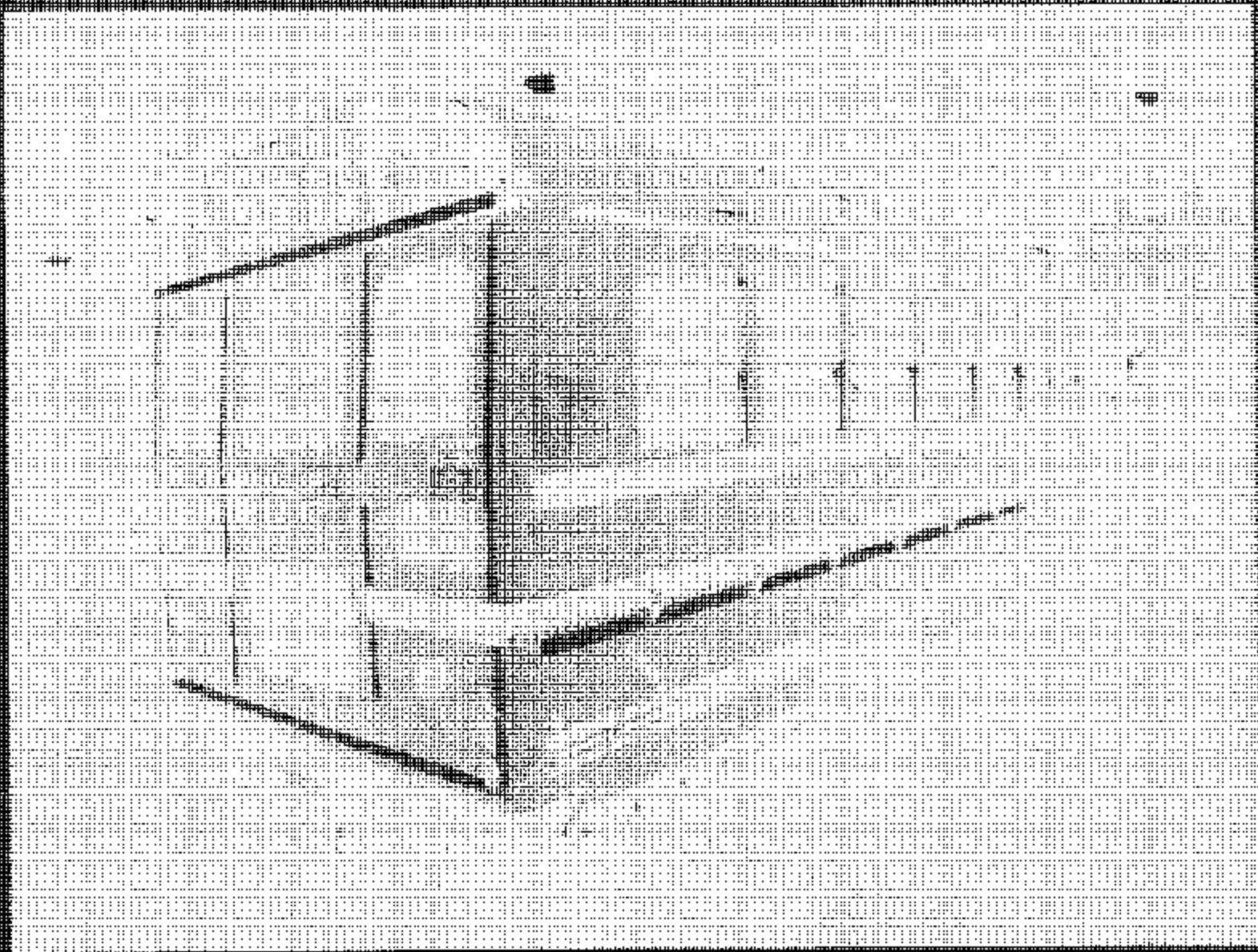

Pre-Front Right Rear View of School Bus

Test Vehicle: 2016 Chevrolet SS Passenger-Rated Base
#-VIN: 1G1115S3000000000

NHTSA No. 0-00002

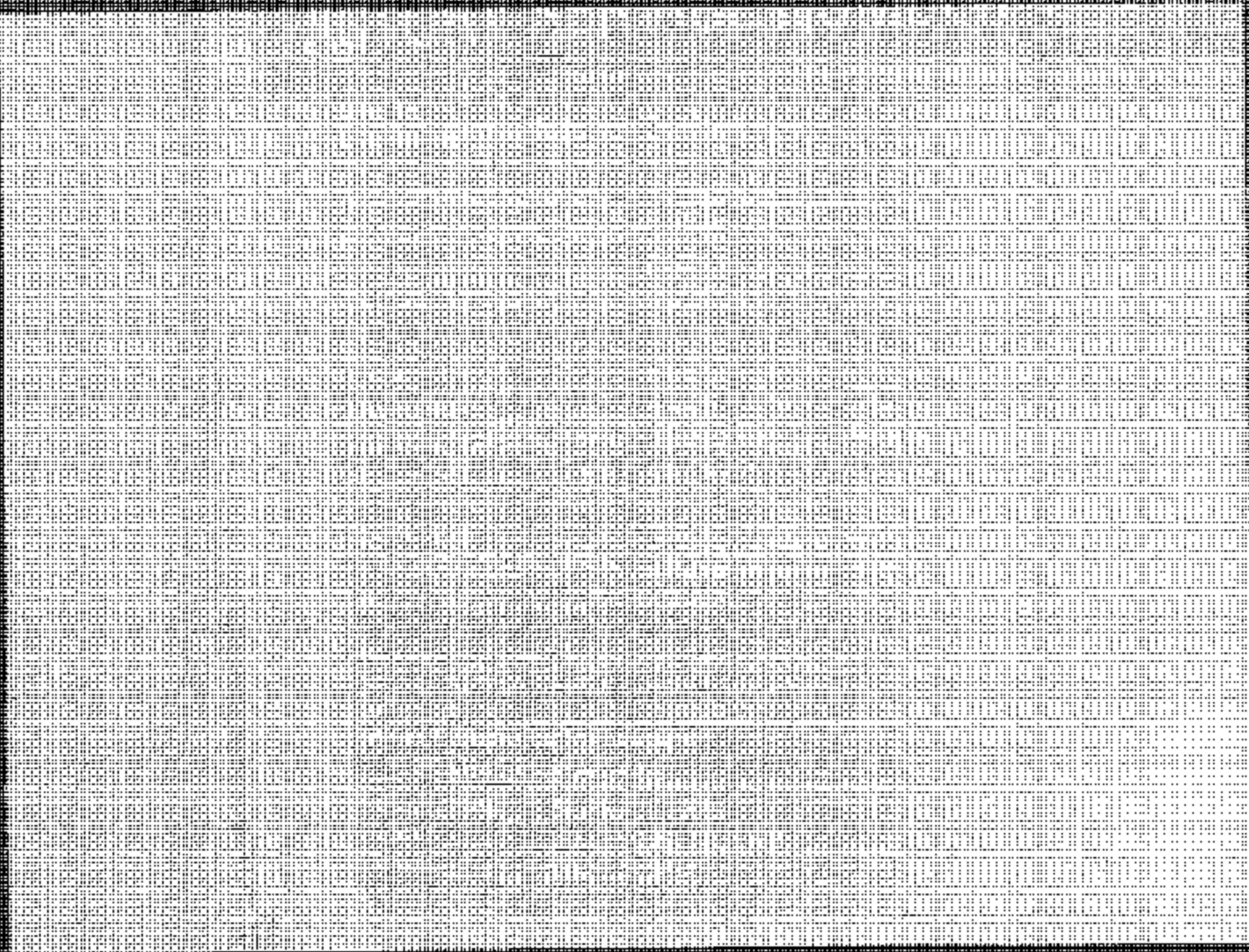

For Usage: 2004 October 30 Passenger Control Dis
Procedure: 00000000

NIRSA No. 640992

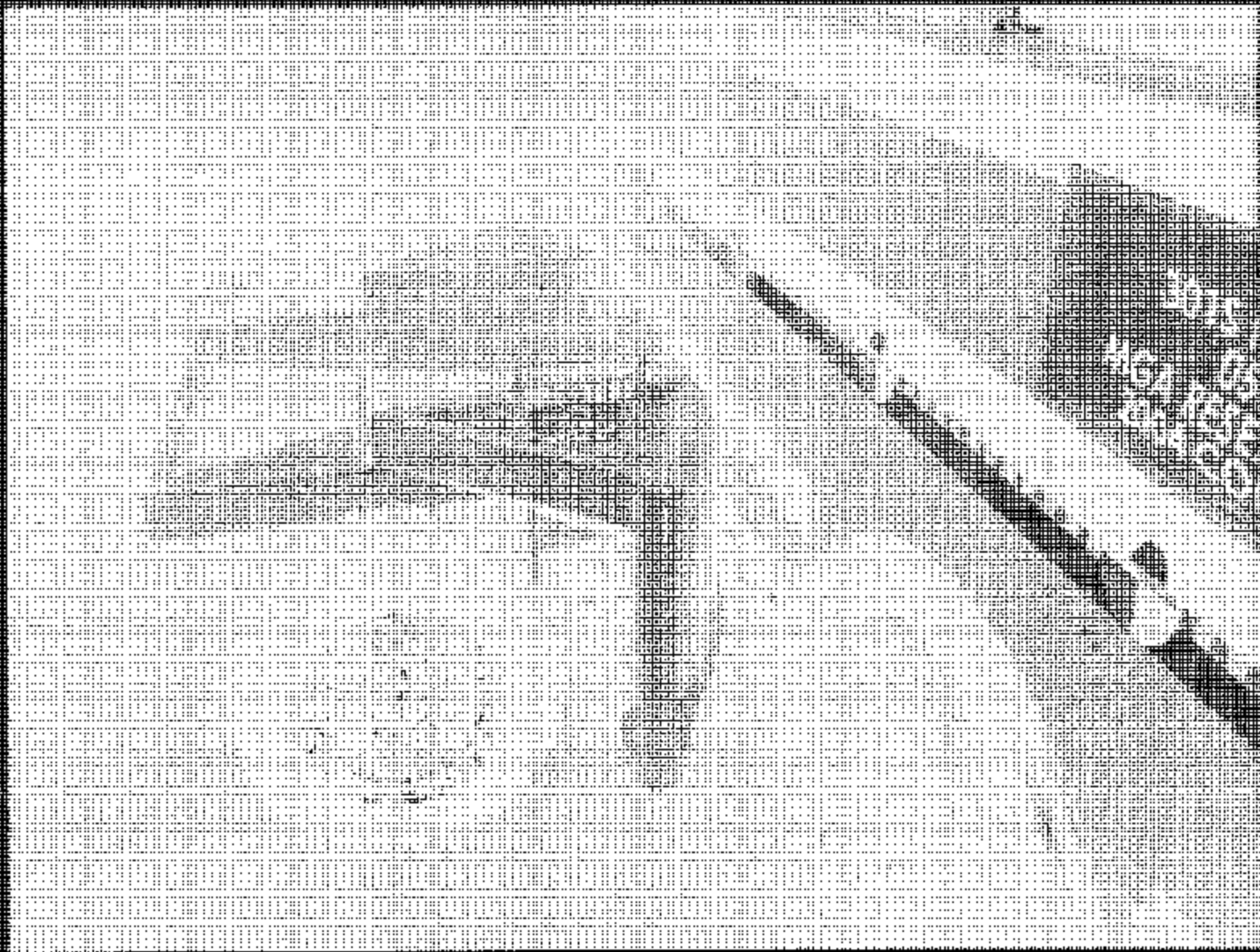

Printed Impact Target

Test No. 101
Procedure

2804 Harbor St. Ponce de Leon School Bus
FEB 25 1971

NHTSA No. 601037

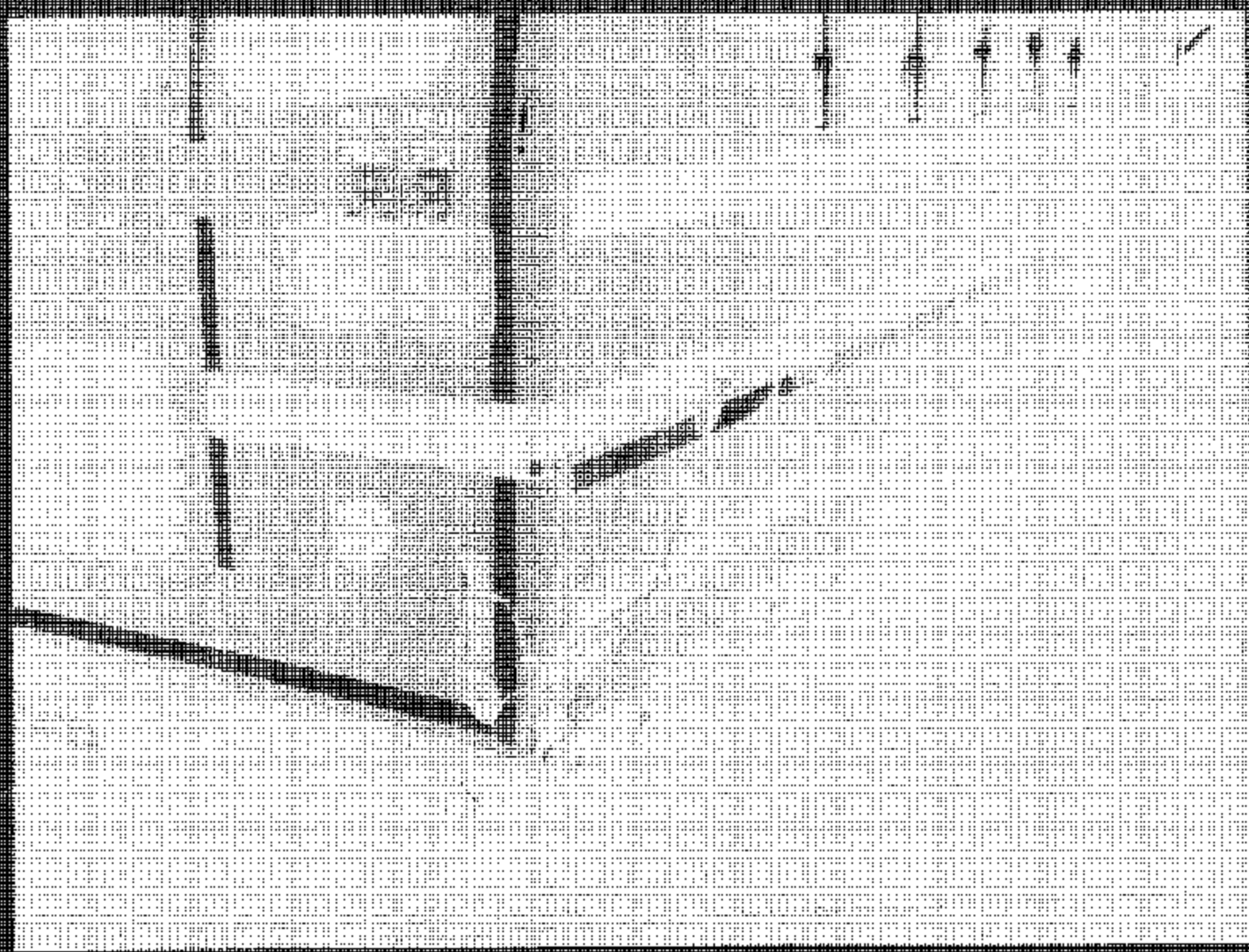

Post-Test of Impact Location

2004 Contract 30 - Pleasure Craftport Site
2004 Contract 30 - Pleasure Craftport Site

NW 1/4 15, 644832

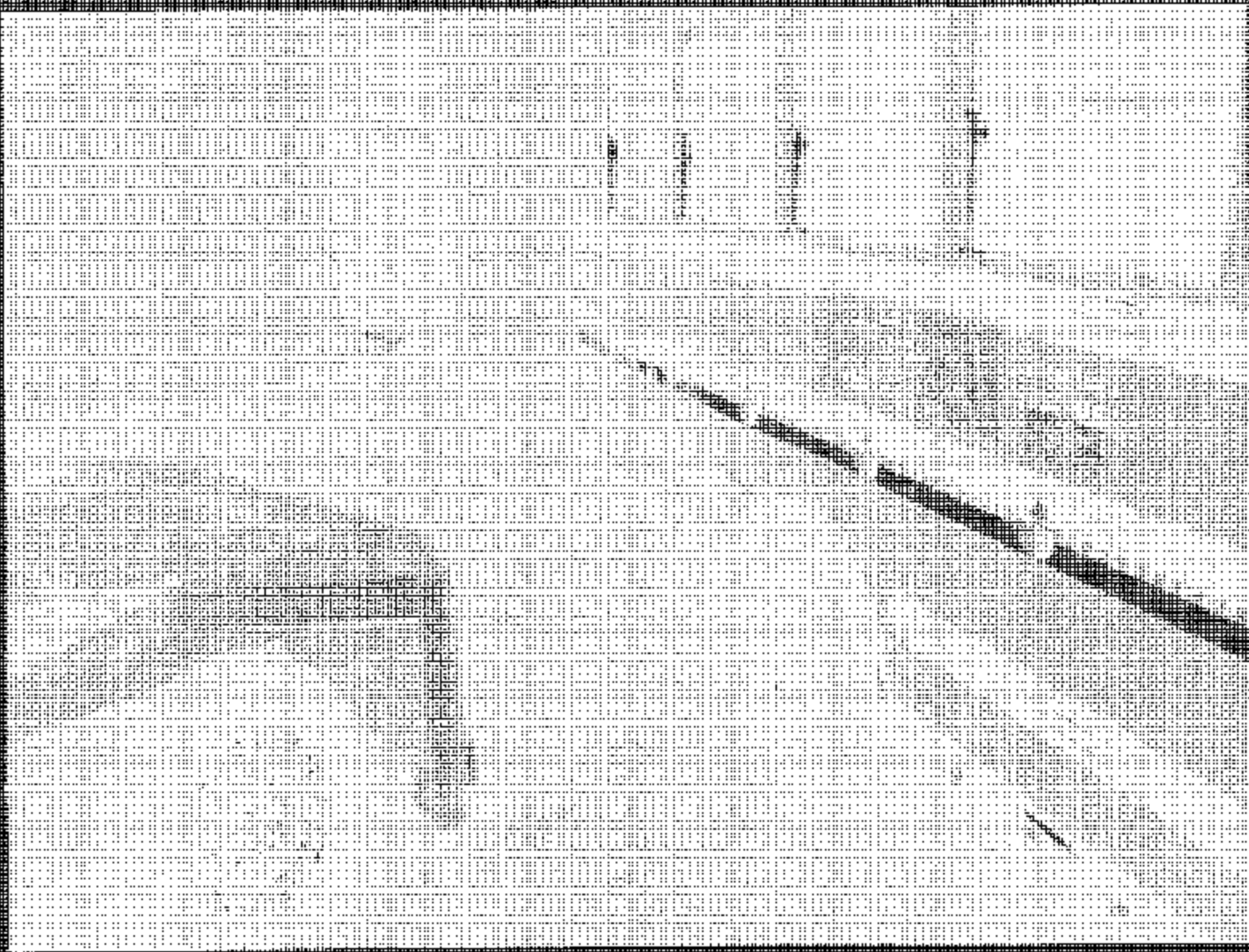

Point Total of project location #2

Test Vehicle: 2014 Chevrolet SS Performance Sedan
Precondition: 2014SS 001

File # 545 No: 443102

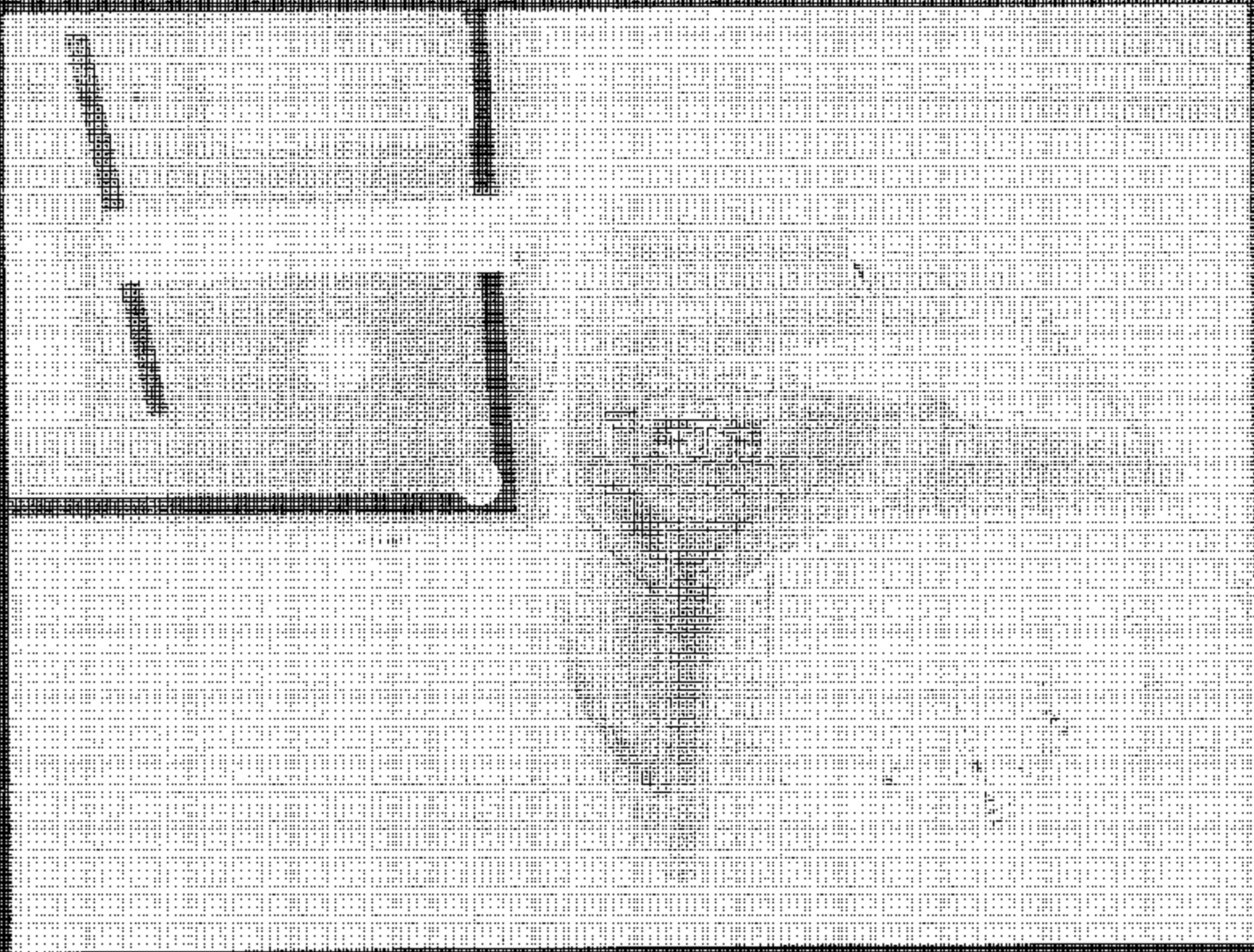

From Test of Barrier Left side

Top Wall
Floor

Architectural Drawing
Floor Plan

Architectural Drawing
Floor Plan

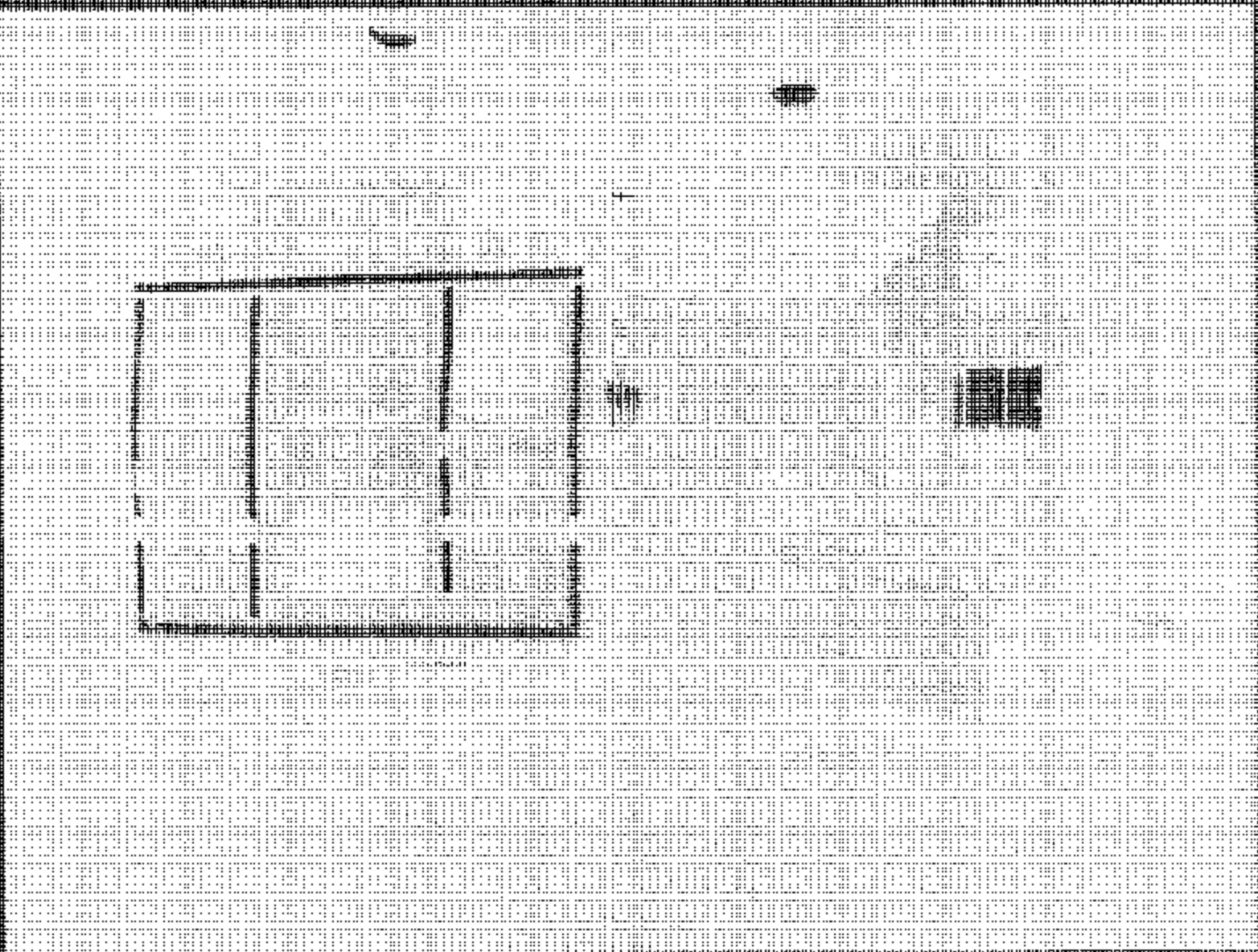

Architectural Drawing
Floor Plan

Test Name: 2004 9월 20일 1차 시험
Frequency: 1회

Test No: C10902

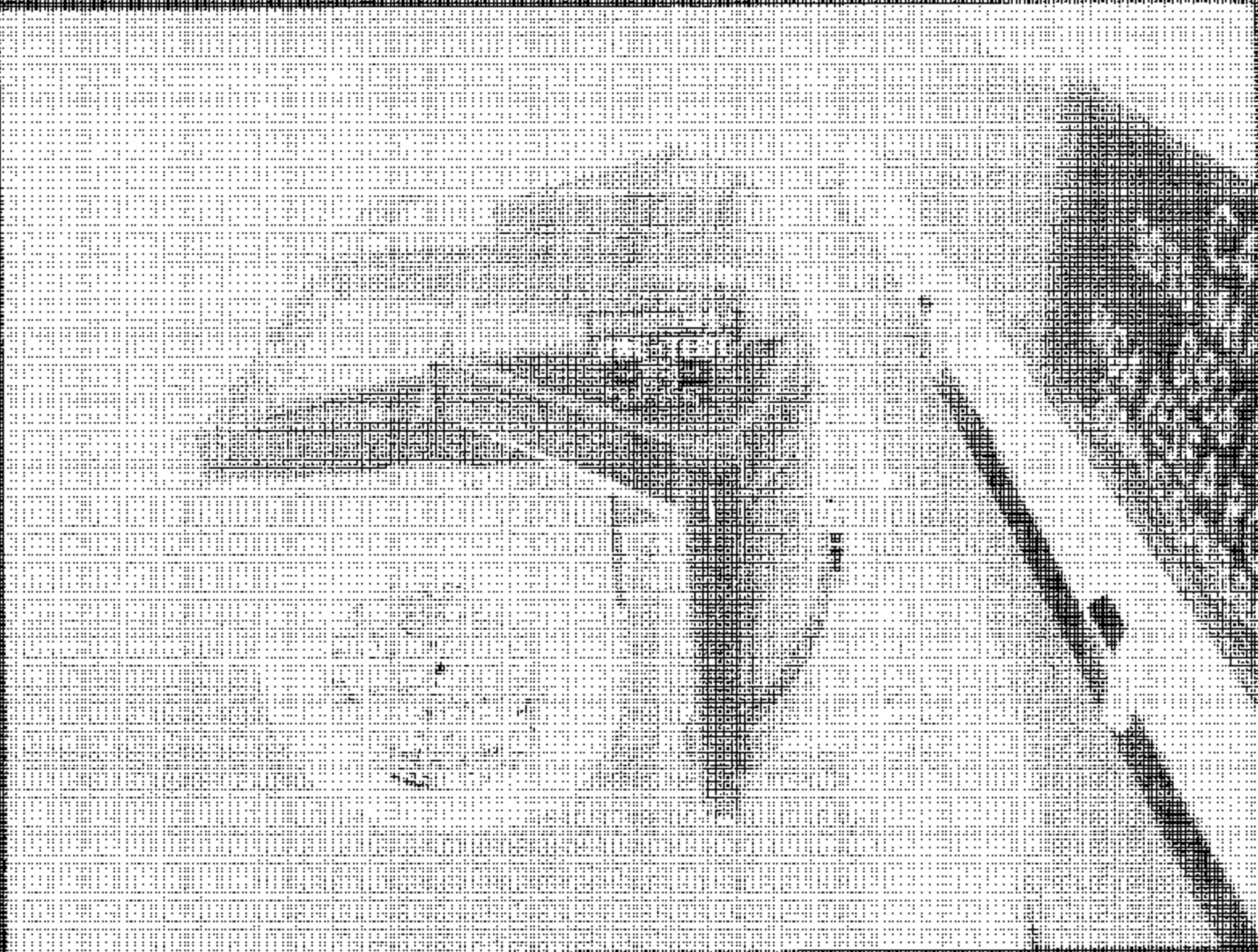

Pre-Test of Banner (right side)

Front Vehicle
2:40:45 PM

2005 Chevrolet SS Passenger - School Bus
PLATES 004

TIME OF No. 014802



Post-Crash of Bus (right side)

Test Vehicle: 2006 Dodge HD Passenger School Bus
Manufacturer: DODGE

NHTSA No: C40232

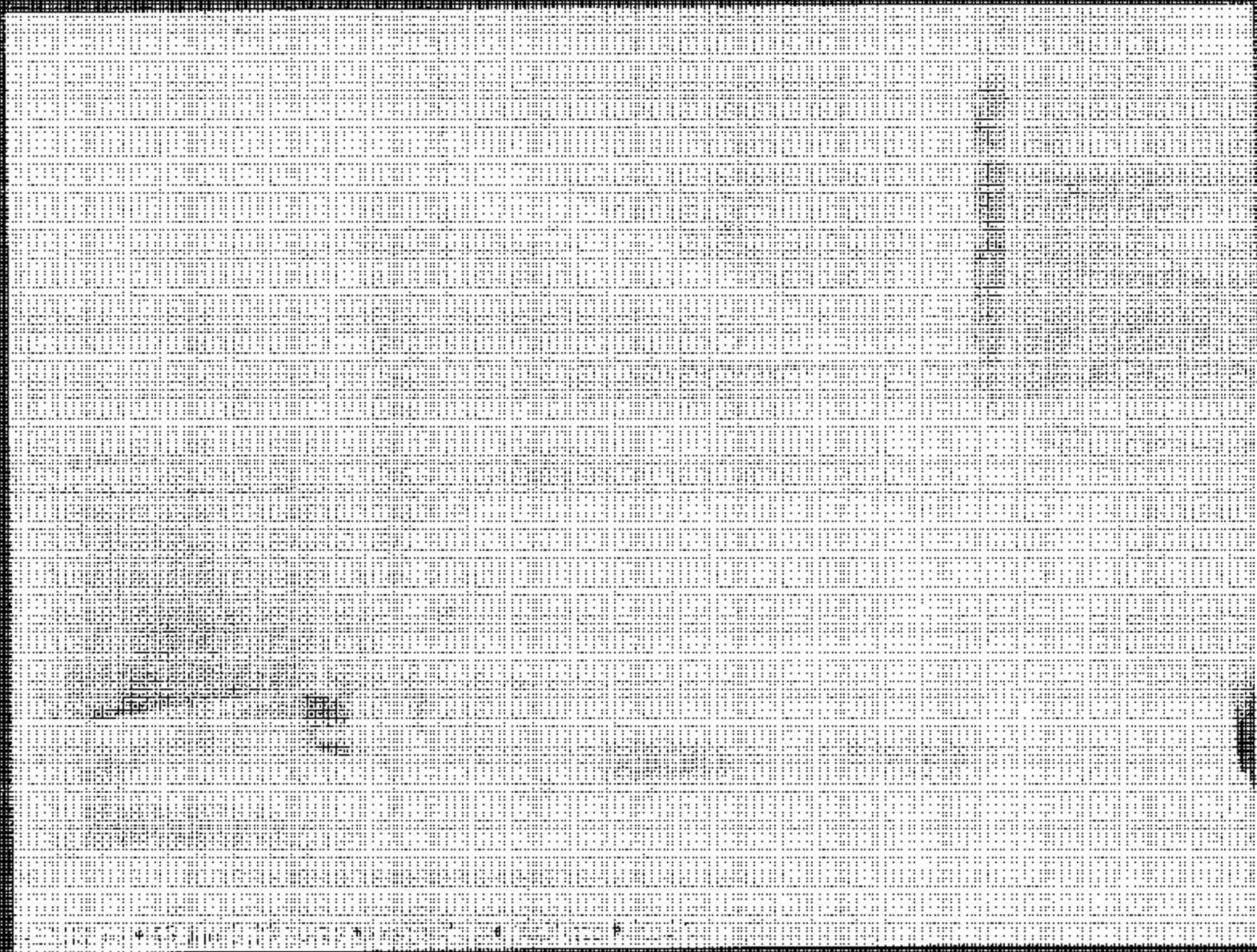

Test Vehicle: 2004 Corolla 30 Passenger School Bus
Procedure: FMVSS 301

NHTSA No.: C44802

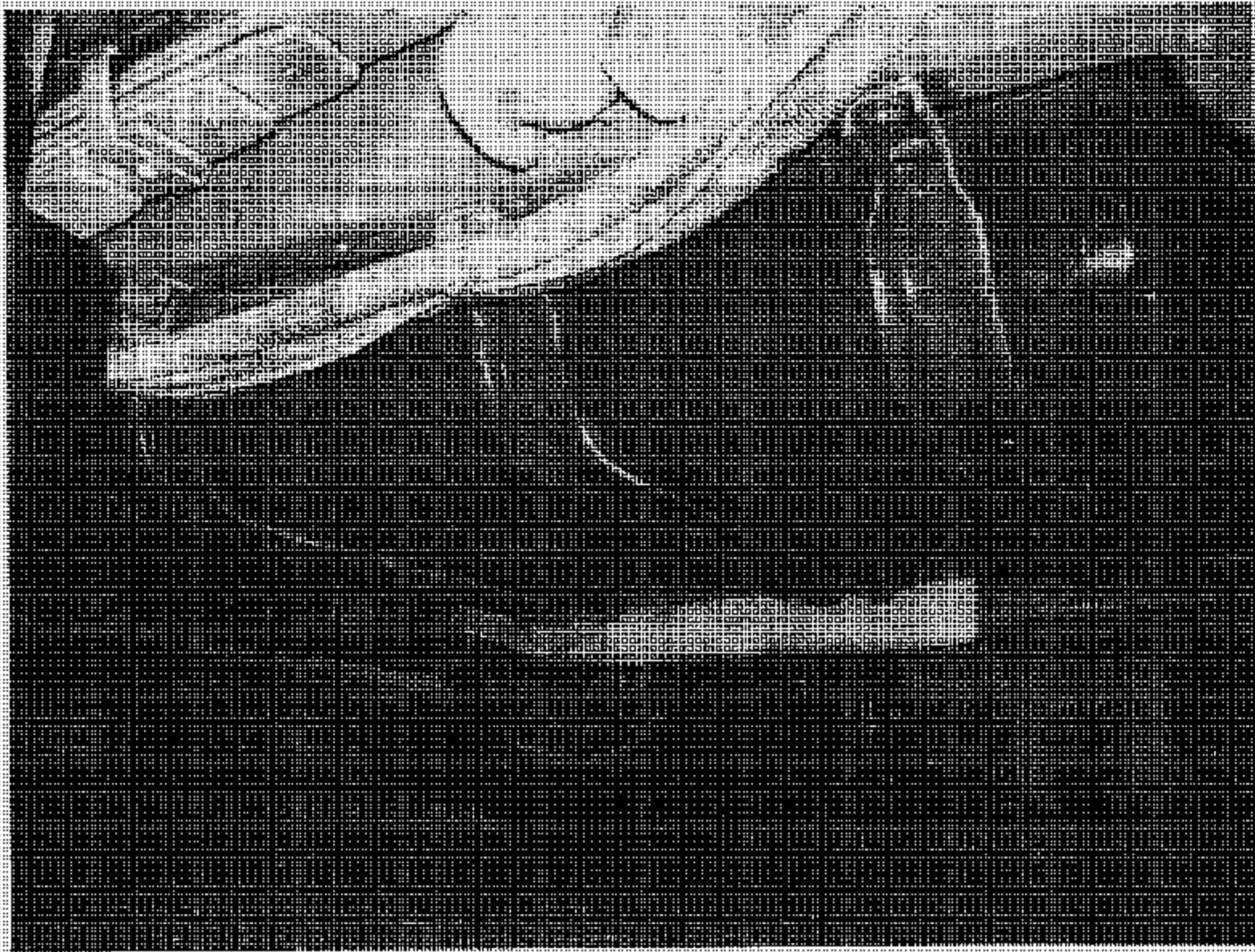

23

Post-Test of Fuel Tank Cage (View #2)

Test/Repair
Procedure

2014 Corolla 50 Passenger Sedan Bus
PMS 001

381754 10 C4H862



Speed Trap Camera Display

True Velocity: 2104 Control of Passenger Boarding Gate
Procedure: RMVSS 901

NHTSA 49 CFR 25.125

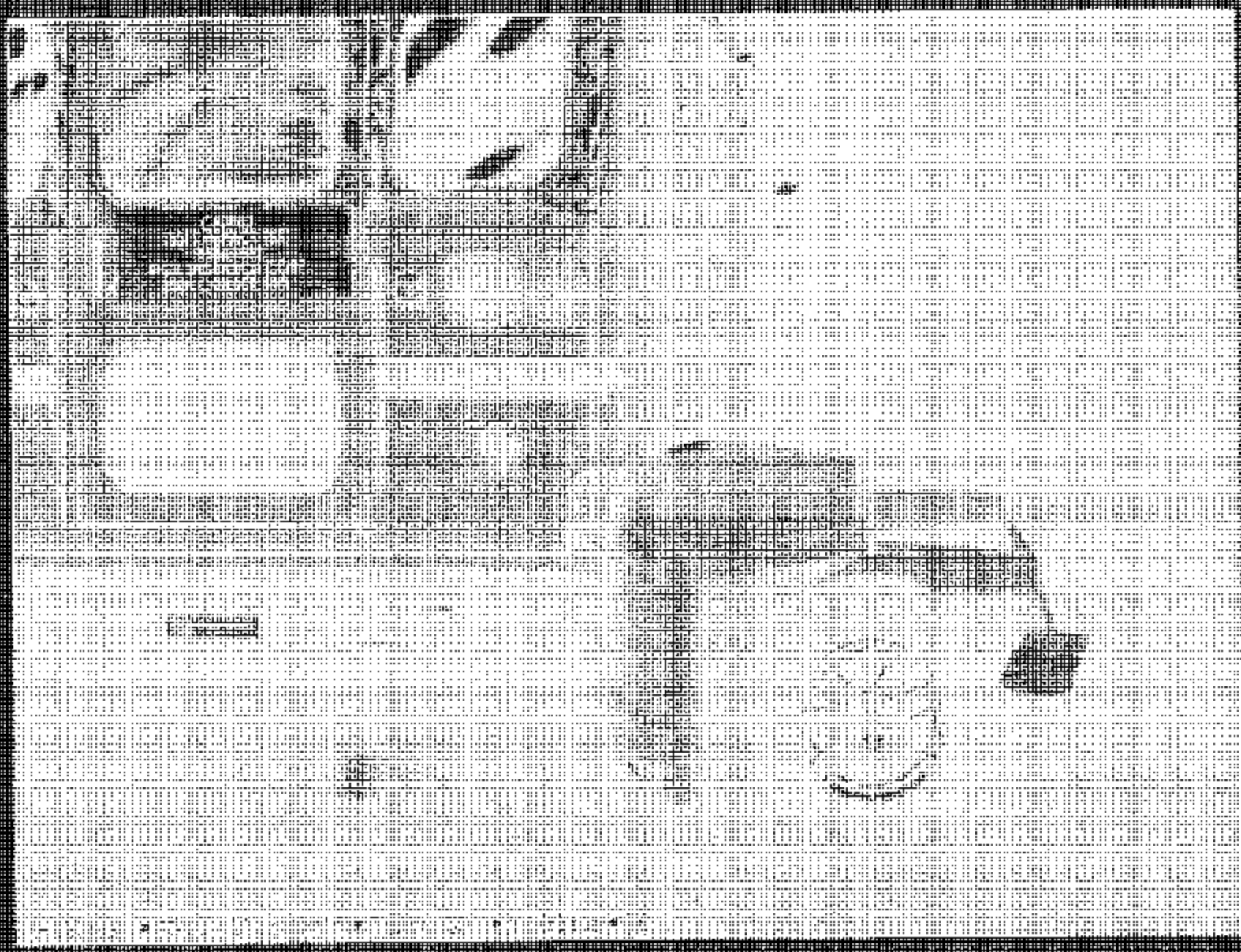

SECTION 5
BARRIER INFORMATION

CONTOURED IMPACT SURFACE FOR COMMON CARRIAGE

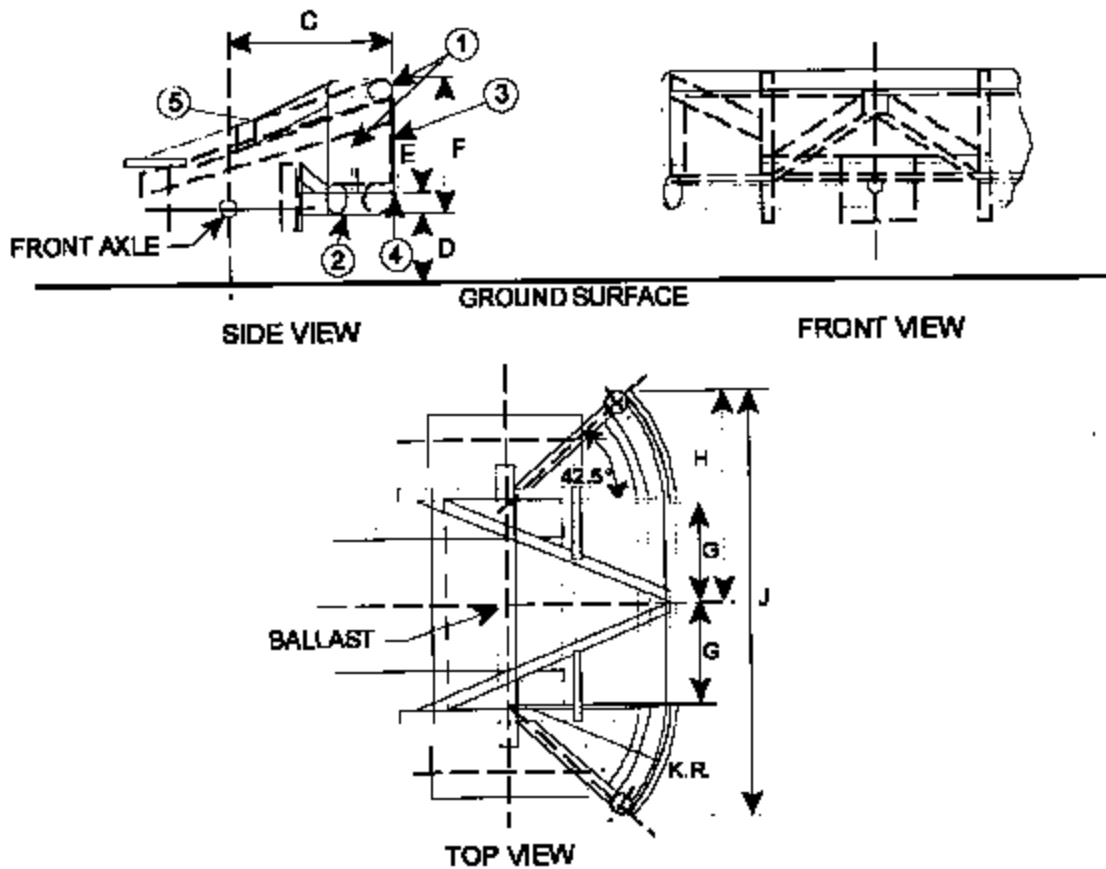

DIMENSIONS SHOWN IN TABLE ON NEXT PAGE

NOTES:

1. Upper Frame 4.0 in. dia x 0.25 in. wall (102 mm dia x 6 mm wall)
Steel Tubing (3 Sides)
2. Lower Frame 6.0 in. dia x 0.50 in. wall (152 mm dia x 13 mm wall)
Steel Tubing
3. Face Plate 0.75 in. (19 mm) thick cold rolled steel
4. Leading Edge 1.0 x 4.0 in. (25 x 102 mm) steel band, sharp
edges broken
5. All Inner Reinforcements 4.0 x 2.0 x 0.19 in. (102 x 51 x 5 mm)
steel tubing

Total Weight = 4,000 ± 50 lbs (1,814.1 ± 22.7 kg)

Weight at each Rear Wheel =
900 ± 25 lbs (408.2 ± 11.3 kg)

Weight at each Front Wheel =
1,100 ± 25 lbs (499.0 ± 11.3 kg)

Moments of Inertia:

$I_x = 271 \pm 13.6 \text{ slug-ft}^2 (367 \pm 18.4 \text{ kg-m}^2)$

$I_z = 3,475 \pm 174 \text{ slug-ft}^2 (4,711 \pm 236 \text{ kg-m}^2)$

DIMENSIONS FOR CONTOURED IMPACT SURFACE

LETTER	INCHES	MILLIMETERS
A	54.0	1372
B	15.8	401
C	30.0	762
D	5.25	133
E	3.75	95
F	24.75	629
G	18.0	457
H	39.0	991
J	78.0	1981
K	30.0	762