



Susana Martinez
Governor

Tom Church
Cabinet Secretary

FOR IMMEDIATE RELEASE

March 2, 2018

MEDIA CONTACT:

Kimberly Gallegos

(505) 639-3576 or Kimberly.Gallegos@state.nm.us

WESTBOUND ON & OFF RAMPS AT THE LOUISIANA INTERCHANGE

CONTACT: Kimberly Gallegos, (505) 639-3576; Kimberly.Gallegos@state.nm.us

FOR IMMEDIATE RELEASE

ALBUQUERQUE—Construction is scheduled to start March 7, 2018 on improvements to the I-40 westbound on-ramp and I-40 westbound off-ramp at the Louisiana Interchange as well as Louisiana Boulevard. The \$4.9 million project is expected to last about six months, through early August 2018.

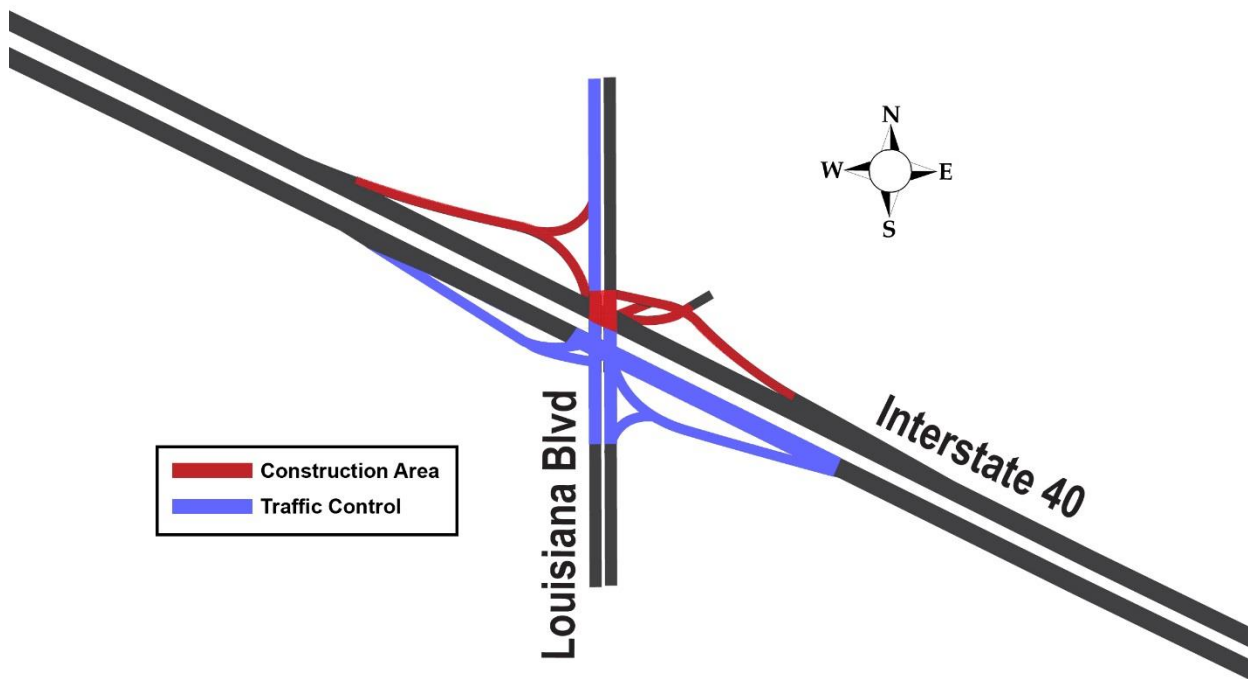

###

The project is another phase of improvements to the I-40/Louisiana Interchange and will include:

- PCCP (Portland Cement Concrete Pavement) reconstruction of I-40 westbound on and off ramps at the interchange and Louisiana Boulevard
- ADA (Americans with Disabilities) improvements to ramps
- Compaction grout injections to reinforce bridges
- New overhead signs and foundations
- Curb and gutter

AUI, Inc. is the general contractor for the project, which will be constructed in two major phases. Construction has been scheduled to minimize impacts to surrounding businesses as well as commuters.

Phase 1, which begins on March 7 and is scheduled to last through early May, will involve compact grout injections to reinforce bridges. All work will be done at night from 9 p.m.-5:30 a.m.

Phase 1 will involve closing some lanes on the on and off ramps and Louisiana, but access will be maintained.

Phase 2 will include pavement reconstruction, overhead signage installation, roadway restriping and ADA ramps and is expected to last through early August.

During portions of Phase 2, on- and off ramps will be completely closed. AUI will work 24 hours a day/7 days a week to complete construction as soon as possible and detours will be signed. Also, this construction will be announced to the public via radio advertisements. In addition, updates will be posted to www.nmroads.com.

The project is being funded by the Federal Highway Administration and the New Mexico Department of Transportation. All construction is scheduled subject to change without notice and weather permitting.

###

###